

SINGER
18U222

MACHINE PARTS CHART
for
SINGER*

18U222

* A Trademark of THE SINGER COMPANY

© THE SINGER COMPANY 1976

Printed in Japan

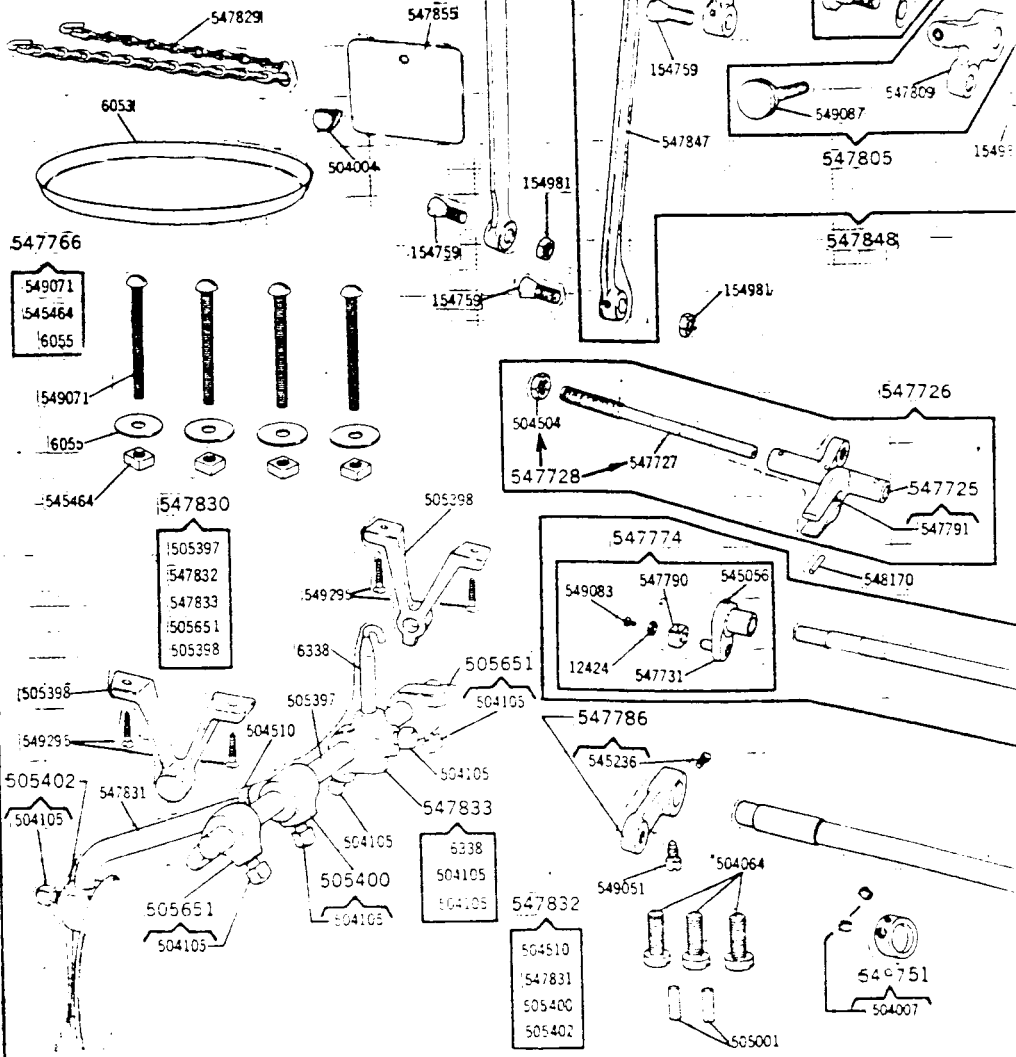
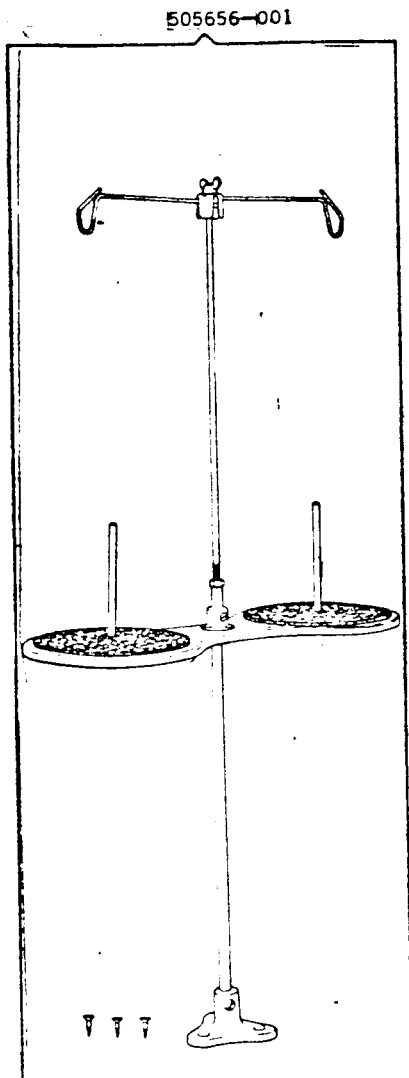
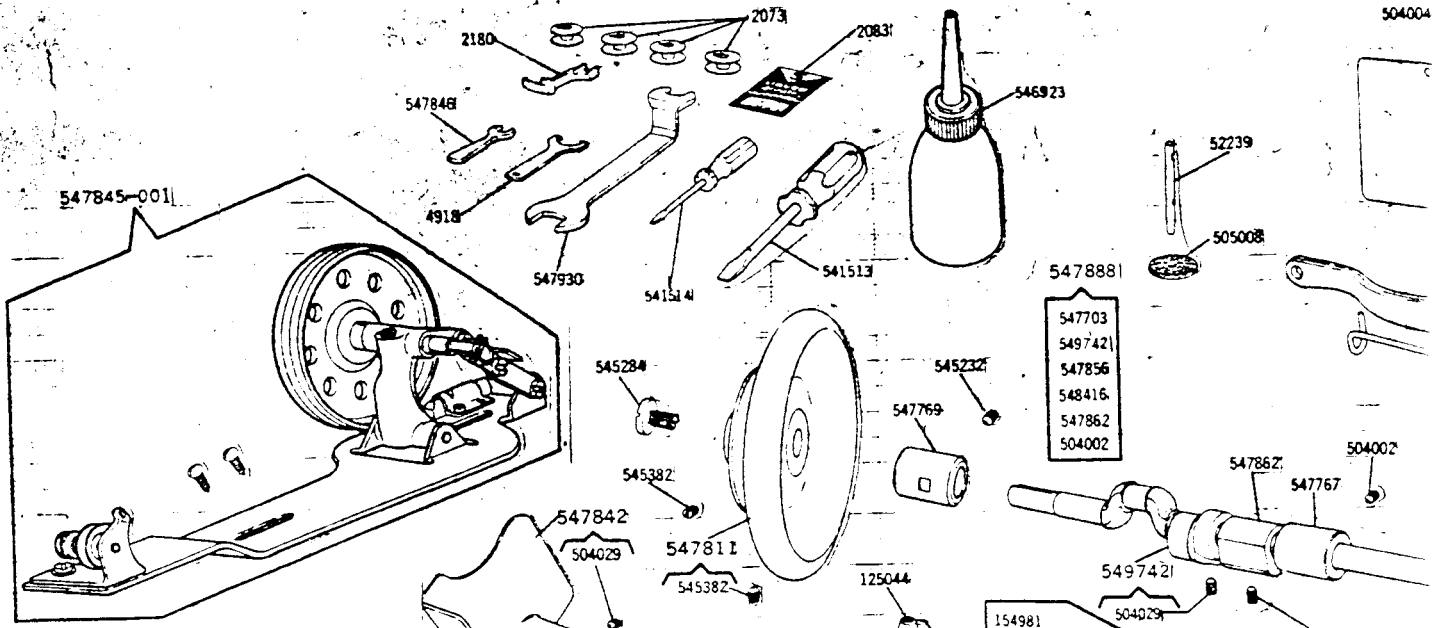

SINGER

18U222

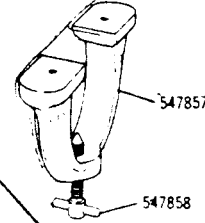
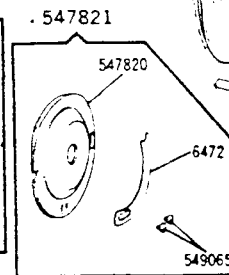
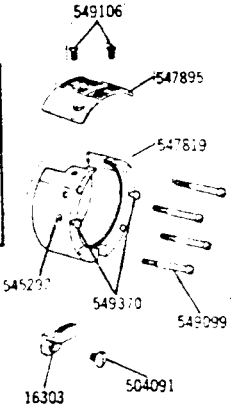
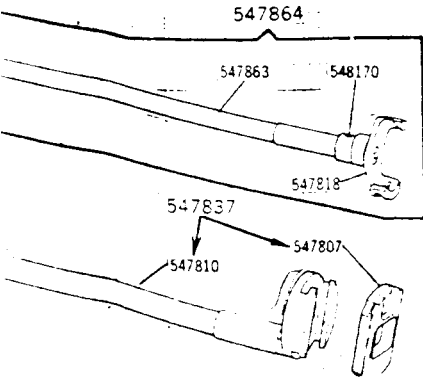
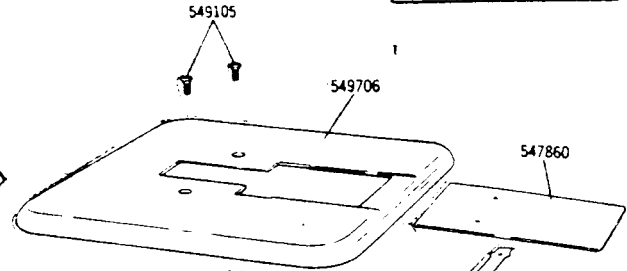
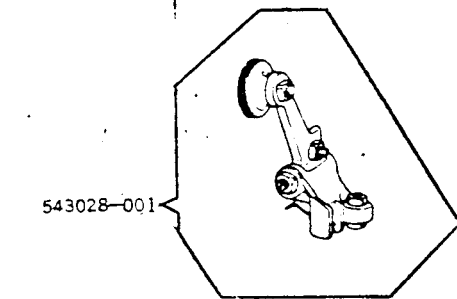
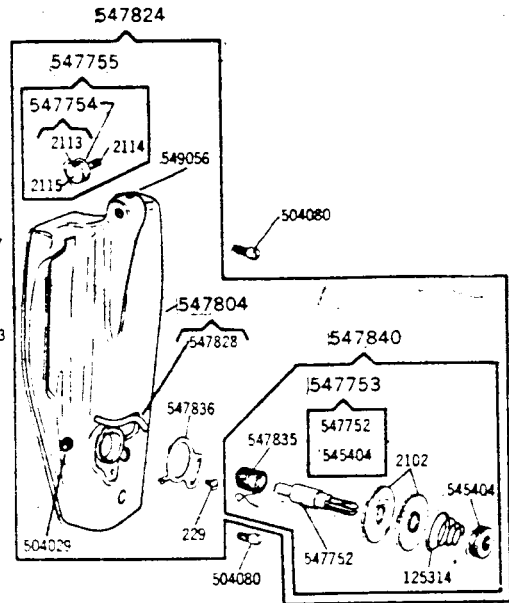
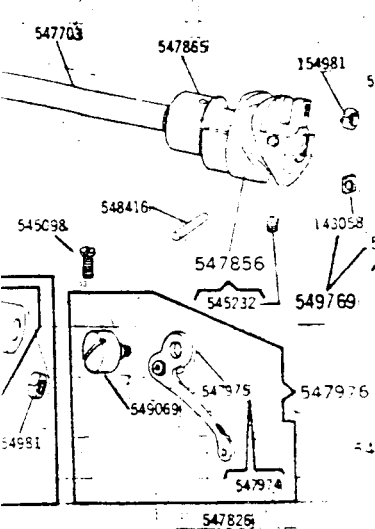
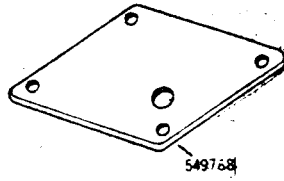
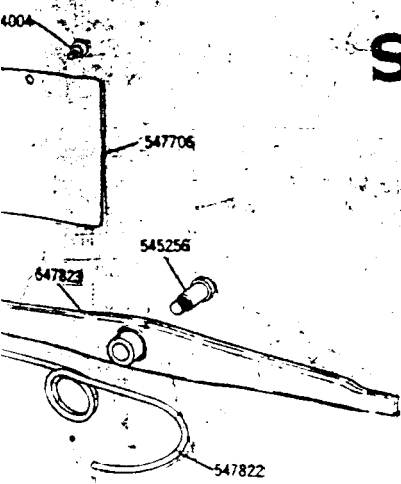
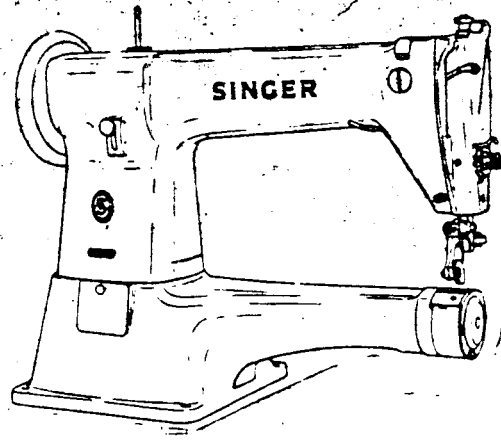

NUMERICAL LIST OF PARTS FOR MACHINE 18U222

<u>PART NO.</u>	<u>DESCRIPTION</u>	<u>PART NO.</u>	<u>DESCRIPTION</u>
229 (839)	Thread Take-up Spring Regulator Plate Adjusting Screw	547780	Feed Rock Shaft Crank with 545236 (803)
2070	Presser Bar Spring Washer	547790	Oscillating Shaft Crank Slide Block
2073	Shuttle Bobbin	547791	Oscillating Rock Shaft Oil Pad (felt)
2102	Tension Disc (2)	547804	Face Plate with 547828
2113	Thread Retaining Disc Steady Pin	547805	Feed Regulator 547809 with 549087 (851)
2114	Thread Retaining Spring	547807	Feed Dog Carrier
2115	Thread Retaining Stud	547809	Feed Regulator
2308	Presser Bar Spring	547810	Feed Rock Shaft
6472	Shuttle Race Cap Latch	547811	Machine Pulley (disc) with two 545382 (850)
12424	Oscillating Shaft Crank Slide Block Cap Screw Washer	547815	Tension Releaser
16333	Feed Dog	547817	Presser Bar Lifter Bracket Lifting Plate
52165	Feed Connecting Link	547818	Shuttle Driver and Feed Lifting Cam
52239	Arm Spool Pin and Thread Eyelet	547819	Shuttle Race
125044	Crank Connecting Rod Oil Pad (felt)	547820	Shuttle Race Cap
125314	Tension Spring	547821	Shuttle Race Cap Complete, Nos. 6472, 547820 and 549065 (810)
139603	Feed Regulator Hinge Screw Friction Washer	547822	Lifting Lever Spring
143058	Needle Bar Connecting Stud Slide Block	547823	Lifting Lever
154759 (850)	Crank Connecting Rod Hinge Screw	547824	Face Plate Complete, Nos. 504029 (833), 549056 (833), 547755, 547835, 547840, 547804 and 229 (809)
154759 (850)	Feed Connecting Link Hinge Screw (2)	547826	Arm Thread Eyelet
154759 (850)	Feed Forked Connection Hinge Screw	547828	Tension Thread Guard
154981 (819)	Crank Connecting Rod Hinge Screw Nut	548935	Thread Take-up Spring
154981 (819)	Feed Connecting Link Hinge Screw Nut (2)	547836	Thread Take-up Spring Regulator Plate
154981 (819)	Feed Forked Connection Hinge Screw Nut	547837	Feed Rock Shaft 547810 with 547807
154981 (819)	Needle Bar Connecting Link Hinge Screw Nut	547838	Needle Clamp (body) 547852 with 549055 (858) and 547839
504002 (850)	Arm Shaft Bushing (Intermediate) Set Screw	547839	Needle Clamp Thread Guide 547851 with 549054 (851)
504002 (850)	Arm Shaft Counterbalance Set Screw	547840	Tension Complete, Nos. 125314, 547835, 547753 and two 2102
504004 (852)	Arm Side Cover Thumb Screw	547842	Belt Safety Guard with two 504029 (833)
504004 (852)	Cylinder Side Cover Thumb Screw	547843	Presser Bar Lifter
504007 (850)	Feed Rock Shaft Collar Set Screw (2)	547847	Feed Forked Connection
504010 (853)	Arm Thread Eyelet Set Screw	547848	Feed Forked Connection Complete, Nos. 547847, 52165, 547805 and two each 154759 (850) and 154981 (819)
504028 (803)	Presser Bar Lifter Bracket Set Screw	547851	Needle Clamp Thread Guide
504029 (833)	Belt Safety Guard Set Screw (2)	547852	Needle Clamp (body)
504029 (850)	Feed Cam Set Screw	547853	Needle Bar Bushing (lower)
504029 (833)	Tension Screw Stud Set Screw	547854	Presser Bar Bushing
504029 (833)	Tension Releaser Collar Set Screw	547855	Cylinder Side Cover
504064 (805)	Arm Screw (3)	547856	Thread Take-up Cam with 545232 (833)
504071 (833)	Crank Connecting Rod Cap Screw (2)	547861	Needle Bar (hollow)
504080 (851)	Face Plate Screw (2)	547862	Arm Shaft Counterbalance
504091 (803)	Feed Dog Screw	547863	Oscillating Shaft
504101 (830)	Belt Safety Guard Shaft Set Screw	547864	Oscillating Shaft 547863 with 547774, 547818 and 548170
504504 (819)	Oscillating Rock Shaft Hinge Pin Lock Nut	547865	Arm Shaft Bushing (front)
505001	Arm Dowel Pin (2)	547888	Arm Shaft 547703 with 549742, 547856, 548416, 547862 and 504002 (850)
505008	Arm Spool Pin Washer (felt)	547892	Presser Bar Lifter Bracket with 504028 (803)
505140	Needle Bar Bushing (upper)	547894	Tension Releaser Collar with 549103 and 504029 (833)
543028-001	Roller Presser Complete (1-1/4 in., fine roller)	547895	Throat Plate
545056 (833)	Oscillating Shaft Crank Set Screw	547961	Belt Safety Guard Shaft
545071 (853)	Needle Bar Connecting Stud Set Screw	547974	Thread Take-up Lever Roller Stud Complete,
545094 (850)	Thread Take-up Lever Hinge Screw Set Screw	547975	Thread Take-up Lever with 547974
545232 (833)	Arm Shaft Bushing (back) Set Screw	547976	Thread Take-up Lever 547975 with 549069 (851)
545232 (833)	Thread Take-up Cam Set Screw	548170	Oscillating Shaft Crank Pin
545236 (803)	Feed Rock Shaft Crank Set Screw	548170	Shuttle Driver and Feed Lifting Cam Pin
545256 (850)	Lifting Lever Hinge Screw	548416	Thread Take-up Cam Pin
545284 (802)	Arm Shaft Screw	549051 (803)	Feed Rock Shaft Crank Position Screw
545292 (803)	Shuttle Race Cap Screw Locking Screw (2)	549052 (803)	Needle Bar Connecting Link Hinge Screw
545382 (850)	Machine Pulley Set Screw (2)	549054 (851)	Needle Clamp Thread Guide Screw
545404 (852)	Tension Disc Regulating Thumb Nut	549055 (858)	Needle Clamp Screw
545456 (851)	Pressure Regulating Thumb Screw Lock Nut	549056 (833)	Thread Retaining Stud Set Screw
547703	Arm Shaft	549057 (810)	Presser Bar Lifter Hinge Screw
547706	Arm Side Cover	549058 (851)	Pressure Regulating Thumb Screw
547707	Crank Connecting Rod with 125044 and two 504071 (833)	549065 (810)	Shuttle Race Cap Latch Screw (2)
547725	Oscillating Rock Shaft with 547791	549069 (851)	Thread Take-up Lever Hinge Screw
547726	Oscillating Rock Shaft Complete, Nos. 547725 with 547728	549074 (803)	Feed Regulator Hinge Screw
547727	Oscillating Rock Shaft Hinge Pin	549083 (809)	Oscillating Shaft Crank Slide Block Cap Screw
547728	Oscillating Rock Shaft Hinge Pin 547727 with 504504 (819)	549087 (851)	Feed Regulator Thumb Screw
547731	Oscillating Shaft Crank with Slide Block Screw Stud	549099 (810)	Shuttle Race Screw (4)
547732	Presser Bar	549102 (810)	Tension Releaser Hinge Screw
547744	Shuttle Bobbin 2073 with 547772	549103 (810)	Tension Releaser Collar Screw Pin
547752	Tension Screw Stud	549106 (806)	Throat Plate Screw (2)
547753	Tension Screw Stud 547752 with 545404 (856)	549147 (803)	Presser Bar Lifter Bracket Lifting Plate Set Screw (2)
547754	Thread Retaining Disc with 2113	549370 (810)	Shuttle Race Cap Screw (2)
547755	Thread Retainer Guide Complete, Nos. 547754 2114 and 2115		
547767	Arm Shaft Bushing (intermediate)		
547769	Arm Shaft Bushing (back)		
547772	Shuttle Body with Cover		
547774	Oscillating Shaft Crank Complete, Nos. 547731 547790, 549083 (809), 12424 and 545056 (833)		

NUMERICAL LIST OF PARTS FOR MACHINE 18U222

<u>PART NO.</u>	<u>DESCRIPTION</u>	<u>PART NO.</u>	<u>DESCRIPTION</u>
549742	Feed Can with 504029 (850)		
549751	Feed Rock Shaft Collar with 504007 (2) (850)		
549754	Needle Bar Connecting Link		
549755	Needle Bar Connecting Link 549754 with 549796		
549757	Needle Bar Connecting Stud with 545071 (819)		
549768	Machine Bed Cushion		
549769	Needle Bar Connecting Stud 549757 with 143058		
CAT. 2083	Needle (16x2, #14) (1)		

ACCESSORIES

(Supplied with Machine)

CAT. 2083	Needle (16x2, #14) (6)
2073	Shuttle Bobbin (4)
2180	Presser Foot
4918	Wrench (for 545456)
6053	Drip Pan
6055	Machine Bolt Washer (4)
505656-001	Thread Unwinder (for two spools) Complete (Include three Wood Screw) (Purchased Assembly)
541513	Screw Driver (Large)
541514	Screw Driver (small)
545464 (809)	Machine Bolt Nut (4)
546923	Oilder (filled with Singer Type "B" Oil)
547766	Machine Bolt 549071 with 545464 and 6055 (4)
547845-001	Universal Bobbin Winder Complete (Include two Wood Screws) (Purchased Assembly)
547846	Wrench (for 545454 and 545455)
547930	Wrench (for 154981)
549071 (809)	Machine Bolt (4)

KNEE LIFTER PARTS

(Fitted to Machine)

6338	Rock Shaft Lifting Bracket Hook
504105 (809)	Rock Shaft Knee Arm Hub Set Screw
504105 (809)	Rock Shaft Knee Plate Set Screw
504105 (809)	Rock Shaft Lifting Bracket Hook Set Screw
504105 (809)	Rock Shaft Lifting Bracket Set Screw
504105 (809)	Rock Shaft Stop Dog Set Screw (2)
504510 (809)	Rock Shaft Knee Arm Clamping Nut
505397	Rock Shaft
505398	Rock Shaft Hanger (2)
505400	Rock Shaft Knee Arm Hub with 504105 (809)
505402	Rock Shaft Knee Plate with 504105 (809)
505651	Rock Shaft Stop Dog with two 504105 (809) (2)
547829	Presser Bar Lifter Lever Chain
547830	Rock Shaft Complete, Nos. 505397, 547832, 547833, two each 505651 and 505398 and four Wood Screws (1 in., No. 10)
547831	Rock Shaft Knee Arm
547832	Rock Shaft Knee Arm Complete, Nos. 504510 (809) 547831, 505400 and 505402
547833	Rock Shaft Lifting Bracket with 6338 and two 504105 (809)
49295	Wood Screw (1" No. 10) (4)

CLOTH PLATE

(Optional Parts)

547849	Cloth Plate Slide Spring
547857	Cloth Plate Bracket
547858 (810)	Cloth Plate Bracket Set Screw
547860	Cloth Plate Slide
549105 (853)	Cloth Plate Screw (2)
549148 (832)	Cloth Plate Slide Spring Screw (2)
549706	Cloth Plate